



Cherry Tree Way Stanmore £729,950

A large and well proportioned two bedroom flat with nearly 1200 square feet of space available chain free in a prestigious block in Stanmore.

The flat has a large, dual aspect reception room with wooden floors and patio doors leading to a private terrace, which in turn leads to well maintained and secure communal gardens. There is a separate, fully fitted kitchen as well as a master bedroom with built-in wardrobes and a large en suite bathroom. In addition the flat has a generous second double bedroom, a family bathroom and lots of storage cupboards.

Cherry Tree Way offers an allocated, secure, off-street parking space for one car as well as additional visitor bays. The block benefits from secure gates, a new video-phone entry system and beautiful communal gardens.

Leasehold with a share of freehold.

Ground Rent Nil.

Service charge of £1435 per six months.

Harrow Council Tax Band F.

- Two bedrooms
- Two bathrooms
- Allocated, gated parking
- Private patio
- Chain free
- Share of freehold

Viewing

Please contact our Davidson Frost-Wellings Office on 020 8954 8806 if you wish to arrange a viewing appointment for this property or require further information.



Floor Plan

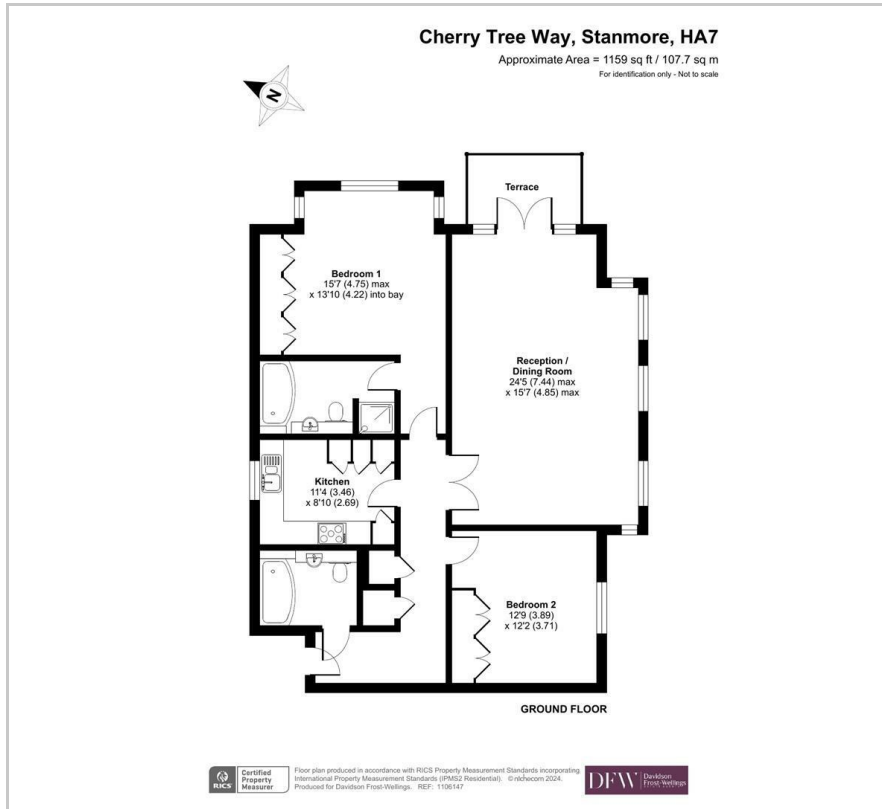

Area Map

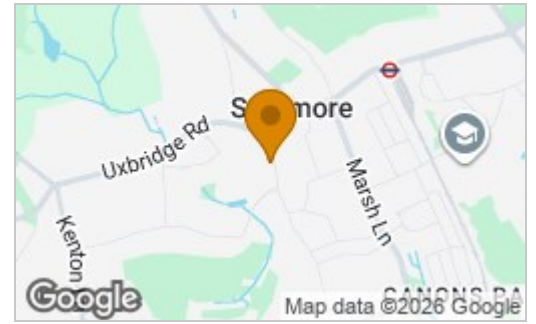

Energy Efficiency Rating		Current	Potential
Very energy efficient - lower running costs			
(92 plus) A			
(81-91) B			
(69-80) C		80	80
(55-68) D			
(39-54) E			
(21-38) F			
(1-20) G			
Not energy efficient - higher running costs			
England & Wales		EU Directive 2002/91/EC	



These particulars, whilst believed to be accurate are set out as a general outline only for guidance and do not constitute any part of an offer or contract. Intending purchasers should not rely on them as statements of representation of fact, but must satisfy themselves by inspection or otherwise as to their accuracy. No person in this firm's employment has the authority to make or give any representation or warranty in respect of the property.